

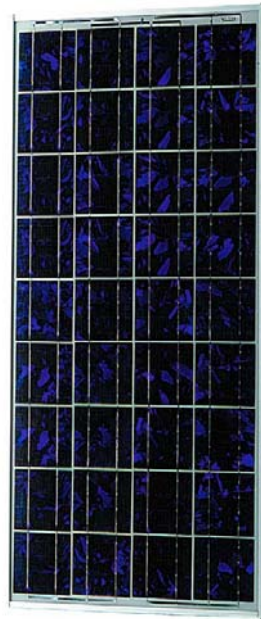

PHOTOWATT PWX850 - 12V

PHOTOVOLTAIC LARGE SCALE POWER MODULE – JBOX

POLYCRYSTALLINE MODULE - LARGE SCAL POWER



| APPLICATIONS |
|-------------------------|
| - Telecommunications |
| - Cathodic protection |
| - Water pumping |
| - Signaling |
| - Rural electrification |
| - Private residences |
| - Commercial buildings |
| - Grid connected |

- Large scale power module
- 4x9 polycrystalline 5 inch cells (125,50 x 125,50 mm)
- **Product warranty : 5 years***
- **Efficiency warranty : 25 years***
- **Quality insurance : ESTI (61215), ISO 9001...**

The PWX850 is designed with the double glass technology, with an optimum configuration that fulfils the most demanding PV applications. That type of heavy-duty construction ensures the product electrical isolation and high durability, including in marine and tropical environments.

The PWX850 module uses Photowatt's multicrystalline technology. The solar cells are individually characterized and electronically matched prior to interconnection. Encapsulation beneath high transmission tempered glass is accomplished using an advanced, UV resistant thermal setting plastic. The encapsulant, ethylene vinyl acetate, cushions the solar cells within the laminate and protects the cells from etching. The PWX500 benefits from excellent mechanicals properties and reliability thanks to its glass both sides.

The self-supporting frame made from anodised aluminium was designed to allow it to be easily mounted either from the front or from the rear.

This module is available in glass / tedlar technology with the PW850 which minimize the weight while providing the same electrical datas.

For building integration, this module can be delivered without aluminium frame. Please contact us for further details.

| PACKING INFORMATION | | |
|----------------------------------|---------|------------------|
| Module weight | Kg | 13 |
| Module size | mm | 1272 x 556 x 39 |
| Packing configuration | modules | 2 per cartons |
| Packing size | mm | 1310 x 600 x 60 |
| Modules packed weight | Kg | 16 |
| Maximum pallet size (34 modules) | mm | 1400 x 880 x 740 |
| Maximum pallet weight | Kg | 324 |



| PWX850 | Configuration 12 V | | | |
|--|--------------------|--|------|------|
| Typical power | W | 75 | 80 | 85 |
| Minimum power | W | 70,1 | 75,1 | 80,1 |
| Voltage at typical power | V | 17 | 17,3 | 17,6 |
| Current at typical power | A | 4,4 | 4,6 | 4,8 |
| Short circuit current | A | 4,7 | 5 | 5,2 |
| Open circuit voltage | V | 21,5 | 21,6 | 21,6 |
| Maximum system voltage | V | 770V DC | | |
| Temperature coefficient | | $\alpha = +1,46 \text{ mA/}^\circ\text{C}$; $\beta = -79 \text{ mV/}^\circ\text{C}$; $\gamma \text{ P/P} = -0,43 \text{ \% /}^\circ\text{C}$ | | |
| Power specifications at 1000 W/m ² : 25 °C : AM 1,5 | | | | |

* According to general warranty conditions



PHOTOWATT

Solutions for natural power

33 Rue Saint Honoré – Z.I. Champfleuri
 38300 Bourgoin-Jallieu - FRANCE
 Phone +33 (0)4 74 93 80 20 - Fax +33 (0)4 74 93 80 40
 www.photowatt.com - marketing@photowatt.com

January 2006 - The characteristics of this document are representative of the products and have no contractual value. Subject to products improvements, Photowatt reserves the right to modify the characteristics without prior notification.

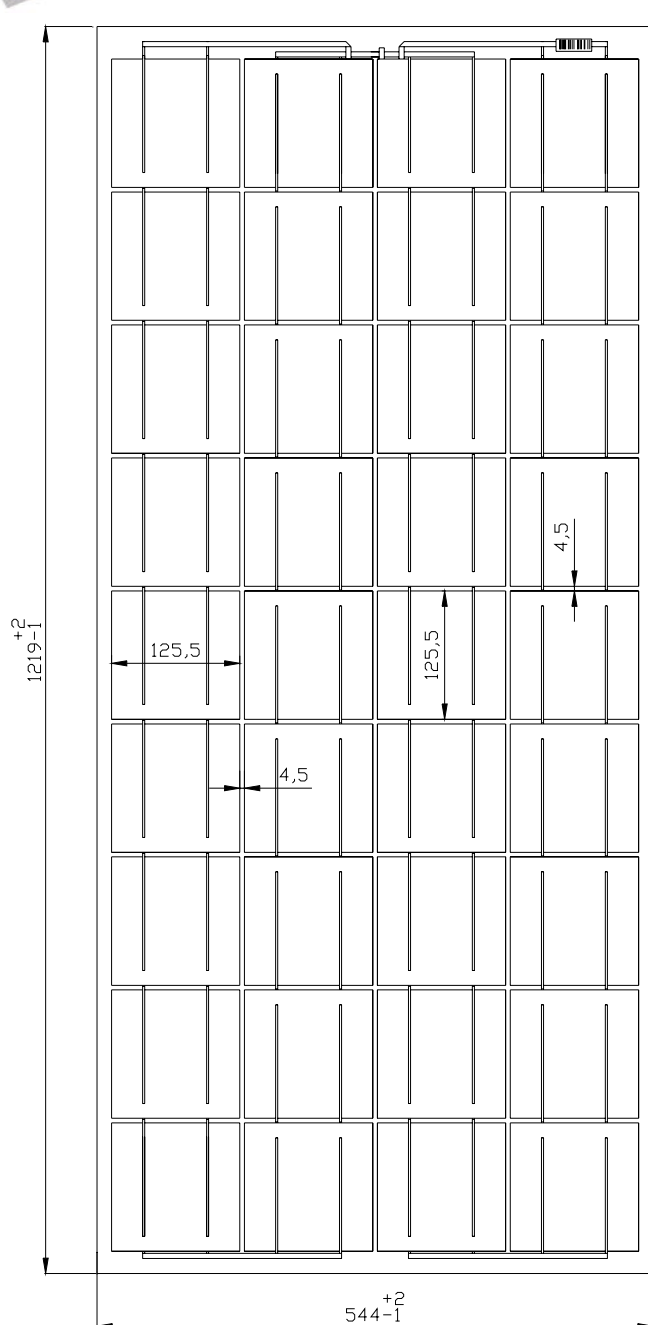

JBOX DETAILS



The universal junction box accepts cables from 1,5 mm² to 4 mm² (AWG 11 to AWG16)

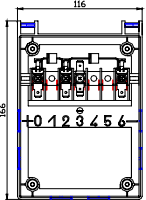

Module protected by 2 by-pass diodes (1 by pass per 18 cells)

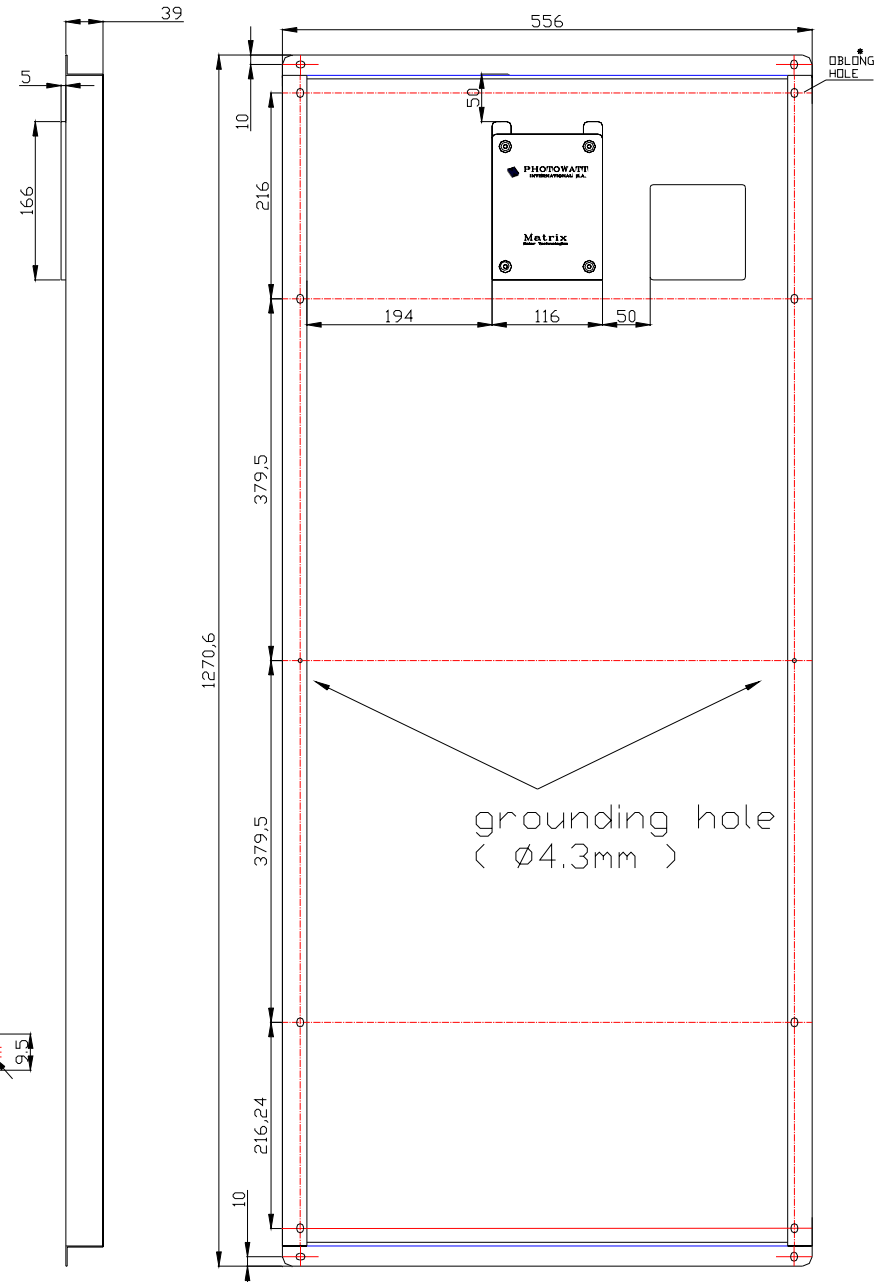
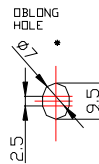

$I=F(V)$ à $E=1 \text{ kW/m}^2$, $AM=1,5$ en fonction de la température

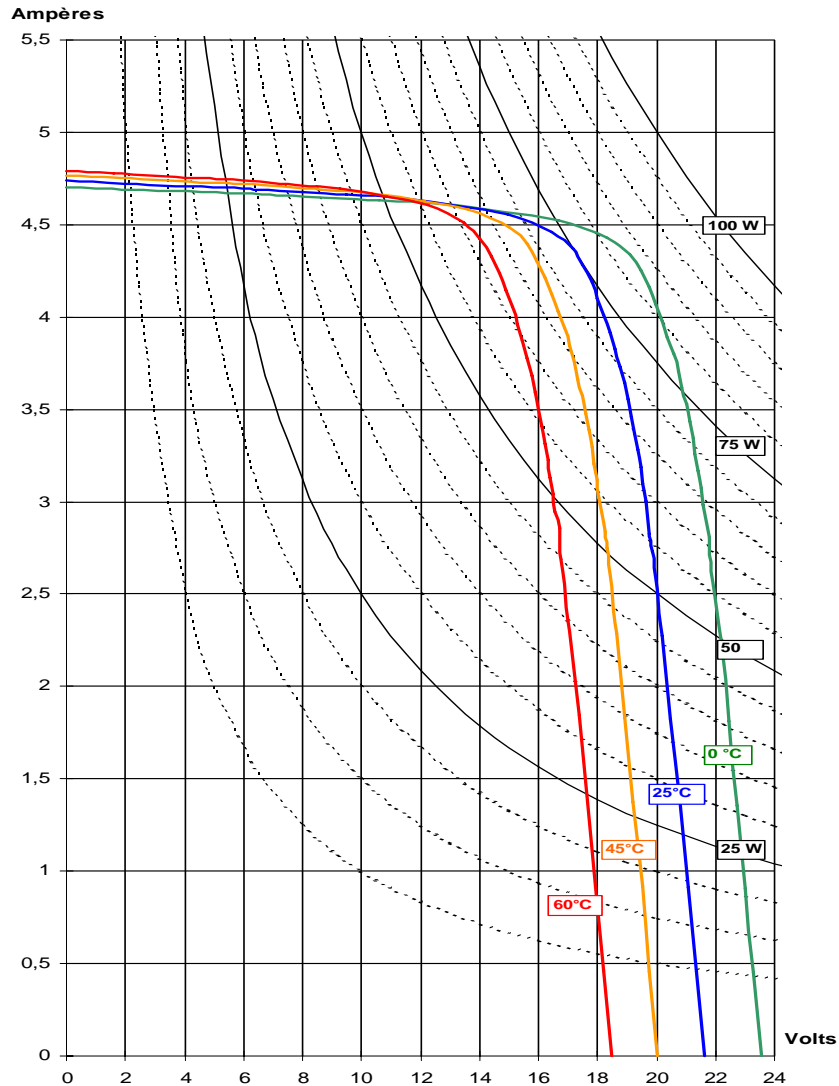

$I=F(V)$ à $T = 25^\circ\text{C}$ en fonction de l'irradiance E (kW / m^2), $AM 1,5$.

